

AVAILABLE FOR LEASE

21,611 SF

# 1105 Stevenson Court - Suite 100E

Roselle, Illinois



For more information, please contact:

**Ron Behm, SIOR**

Principal  
847-698-8210  
rbehm@colliersbk.com

**Brian Kling**

Vice President  
847-698-8223  
bkling@colliersbk.com



[www.colliersbk.com](http://www.colliersbk.com)

Colliers Bennett & Kahnweiler Inc.  
6250 N. River Road, Suite 11-100,  
Rosemont, Illinois 60018  
tel 847-698-8444 fax 847-698-8445



A JAMES CAMPBELL COMPANY PROPERTY

Available:	21,611 SF	Rental Rate:	\$5.15 PSF
Building Size:	71,298 SF	Real Estate Taxes:	\$1.02 PSF
Office size:	2,100 SF	CAM:	\$0.71 PSF
Loading:	4 exterior docks	Easy Access to major expressways (Elgin - O'Hare/I-290/I-355)	
Sprinklers:	Fully	Low DuPage County Taxes	
Clear Height:	22' clear	1,000 SF temperature controlled room	
Built:	1987		
Bay Size:	30' x 40'		



AVAILABLE FOR LEASE

21,611 SF

1105 Stevenson Court - Suite 100E

Roselle, Illinois

Site Plan

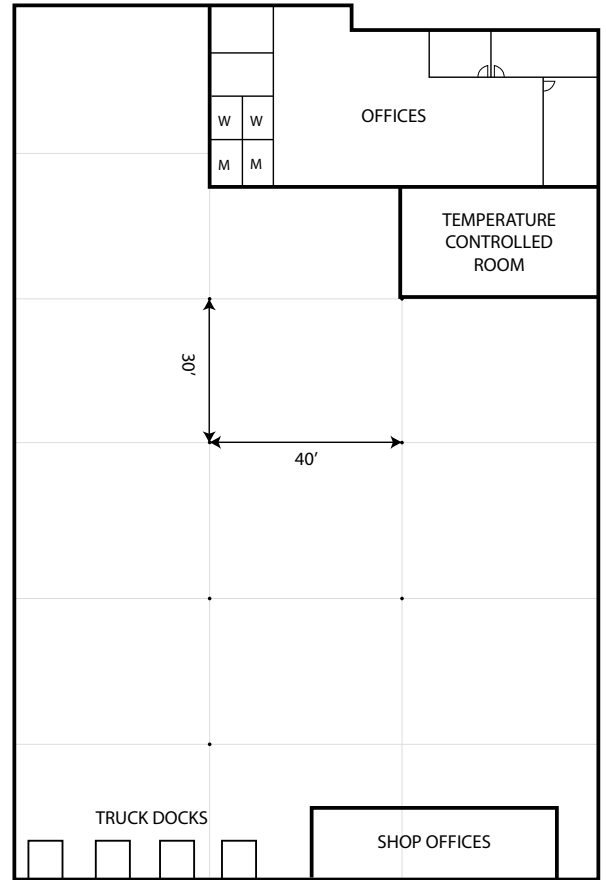
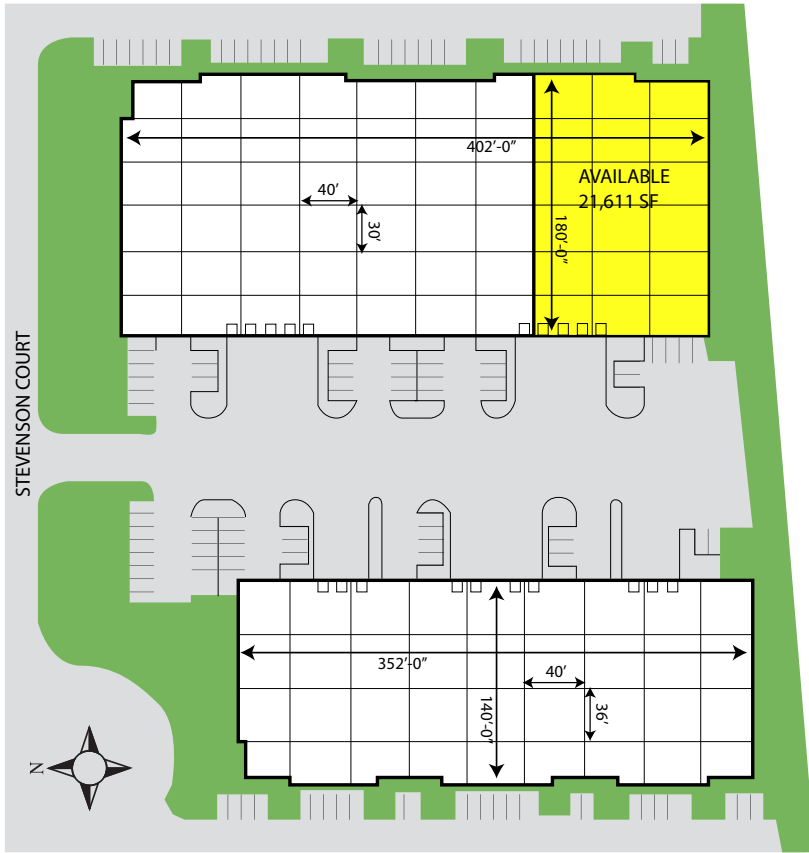

For more information, please contact:

**Ron Behm, SIOR**

Principal

847-698-8210

rbehm@colliersbk.com

**Brian Kling**

Vice President

847-698-8223

bkring@colliersbk.com



www.colliersbk.com

Colliers Bennett & Kahnweiler Inc.  
 6250 N. River Road, Suite 11-100,  
 Rosemont, Illinois 60018  
 tel 847-698-8444 fax 847-698-8445



No warranty or representation is made to the accuracy of the foregoing information. Terms of sale or lease and availability are subject to change or withdrawal without notice.