



AVAILABLE FOR LEASE

1301 Armitage Avenue
Melrose Park, Illinois



AVAILABLE SPACE: 20,000 SF
 BUILDING SIZE: 110,000 SF
 SITE SIZE: 6.38 acres
 CEILING HEIGHT: Part 14' and part 18' clear
 LOADING DOCKS: 1 interior dock
 DRIVE-IN DOOR: 1
 BAY SIZES: 25' x 38'
 SPRINKLERS: Wet system
 HEAT: Gas units
 POWER: 600 amps @ 240 volts
 PARKING: Ample
 LEASE RATE: \$5.50/SF Gross
 YEAR BUILT: 1961 / 1966
 CONSTRUCTION: Masonry

For More Information Contact:
 Steven A. Kohn, SIOR
 (847) 698-8224
skohn@colliersbk.com

Vernon F. Schultz, SIOR
 (847) 698-8233
vschultz@colliersbk.com

John Hamilton
 (847) 698-8247
jhamilton@colliersbk.com



AVAILABLE FOR LEASE

1301 Armitage Avenue
Melrose Park, Illinois

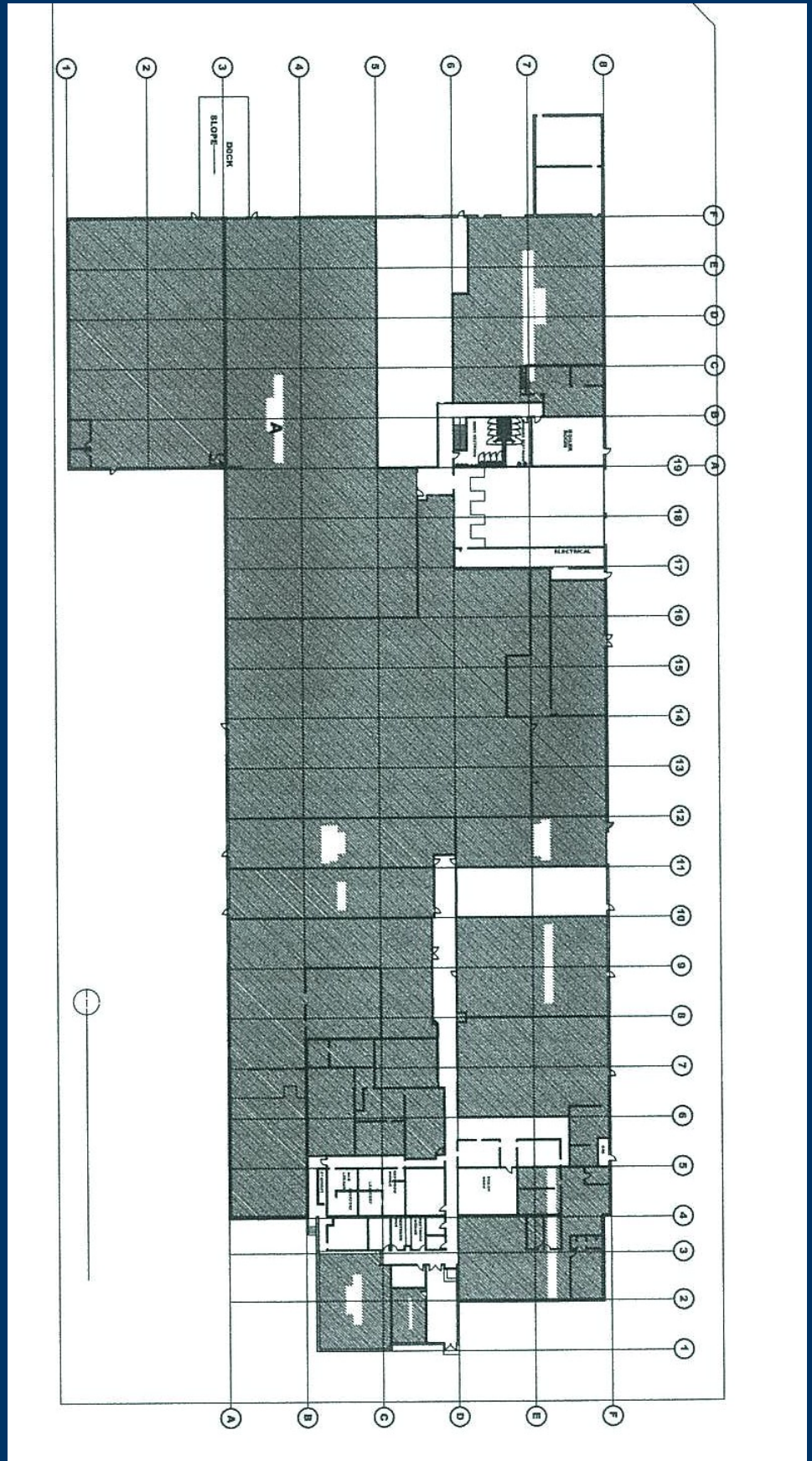

For More Information Contact:

Steven A. Kohn, SIOR
(847) 698-8224
skohn@colliersbk.com

Vernon F. Schultz, SIOR
(847) 698-8233
vschultz@colliersbk.com

John Hamilton
(847) 698-8247
jhamilton@colliersbk.com