

AVAILABLE FOR LEASE

1376 Industrial Drive - Itasca, IL



BUILDING SPECIFICATIONS

SPACE AVAILABLE:	85,550 SF Divisible to 53,144 SF and 32,412 SF
OFFICE:	8,042 SF
SITE SIZE:	3.59 Acres
CONSTRUCTION:	Pre-cast concrete panels
LOADING:	6 Interior docks with levelers 2 Drive-in doors
ROOF:	45 mil EPDM; Roof was replaced in Fall 2005. It has a ten year warranty
CEILING HEIGHT:	24'
BAY DEPTH:	38' x 39'
PARKING:	81 stalls
YEAR COMPLETED:	1985
RAIL:	3 rail doors
LEASE RATE:	\$0.99/SF Net



Matthew J. Stauber, SIOR
847-698-8236
mstauber@colliersbk.com

Thomas C. Rodeno
847-698-8231
trodeno@colliersbk.com

Joseph Reiff
847-698-8225
jreiff@colliersbk.com

AVAILABLE

1376 Industrial Drive - Itasca, IL

CRP

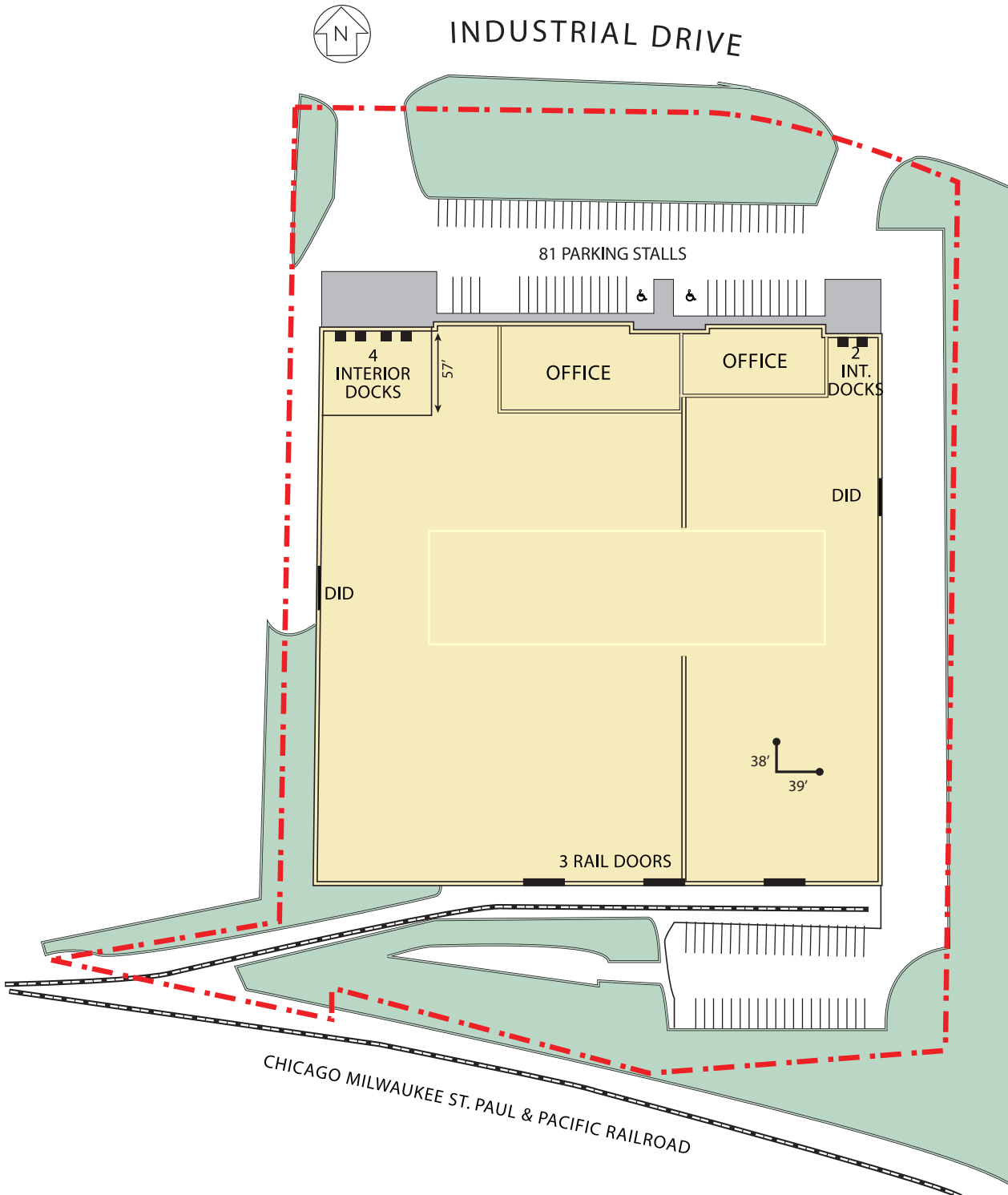

Matthew J. Stauber, SIOR

847-698-8236
mstauber@colliersbk.com

Joseph Reiff

847-698-8225
jreiff@colliersbk.com

Thomas C. Rodeno

847-698-8231
trodeno@colliersbk.com

AVAILABLE

1376 Industrial Drive - Itasca, IL

CRP



Matthew J. Stauber, SIOR
847-698-8236
mstauber@colliersbk.com

Thomas C. Rodeno
847-698-8231
trodeno@colliersbk.com

Joseph Reiff
847-698-8225
jreiff@colliersbk.com

AVAILABLE
1376 Industrial Drive - Itasca, IL

CRP



Matthew J. Stauber, SIOR
847-698-8236
mstauber@colliersbk.com

Thomas C. Rodeno
847-698-8231
trodeno@colliersbk.com

Joseph Reiff
847-698-8225
jreiff@colliersbk.com